

of the County Treasurer,

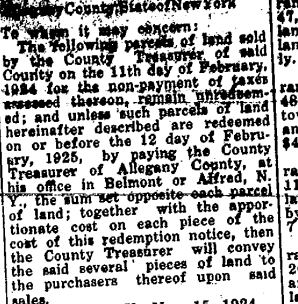

What to Creditors

of lot 8, A. by lands of Reynolds,
N. by Erie Railroad Co., S. by high-
way, W. by Potter, $\frac{1}{4}$ acre. \$35.45.

Town of Burns

Cert. No. 6.—PHELPS & Gorman
Purchase, range 7, township 5, part
of lot 100, Charles C. Phelps, bounded
N. by town line, E. and S. by lands
of Bacon, W. by highway, $2\frac{1}{2}$ acres.
\$22.98.

Cert. No. 7.—PHELPS & Gorman
Purchase, range 7, township 5, part
lot 107, estate of David C. Phelps,
E. bounded N. by lands of Curry, E.
and S. by lands of Kreidler, W. by
highway, $\frac{1}{4}$ acre. \$4.98.

Cert. No. 8.—PHELPS & Gorman
Purchase, range 7, township 5, part
of lot 62, William Swain, bounded
N. by lands of Steich, E. by lands
of Miller, S. by lands of Hungerford
and W. by lands of Hann, $7\frac{1}{2}$ acres.

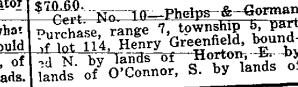

Figure 24

.....